

# Wireless battery camera

## User Quick Manual

Dear Customer, thank you for choosing our products! to have better operation we suggest you read the User Manual first and keep it for future reference

If any questions please contact us by email to our support team for helps.

### Introduction

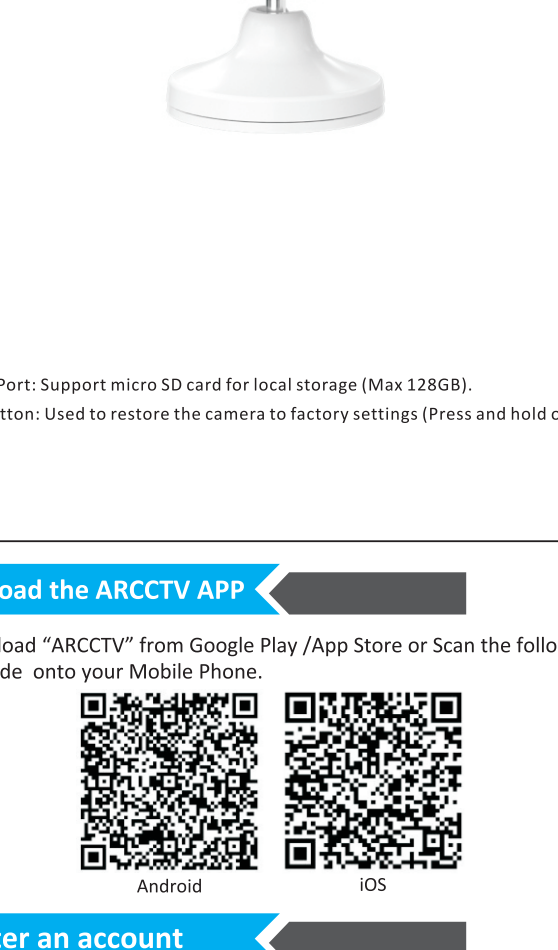

SD Card Port: Support micro SD card for local storage (Max 128GB).

Reset button: Used to restore the camera to factory settings (Press and hold on 5-6s).

### Download the ARCCTV APP

Download “ARCCTV” from Google Play /App Store or Scan the following QR Code onto your Mobile Phone.

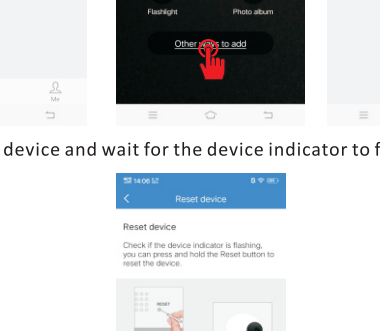

### Register an account

1. Open the “ARCCTV” APP to register an account. Go to the login interface then click “Register” (Figure 1)
2. Register with your phone number or email address, click “Confirm”, a verification code will be sent to your phone or email-box (Figure 2)
3. Input the verification code and set a password for the app account, click “Confirm” to complete (Figure 3)



### Set up WiFi for the camera

**Step1.** Put both of your mobile phone and camera near the router, and the distance should be 5-10m.

**Step2.** Log in to “ARCCTV”, then tap the “+” icon in the center.

Tap “Other ways to add”, select “Add battery camera” to add device.

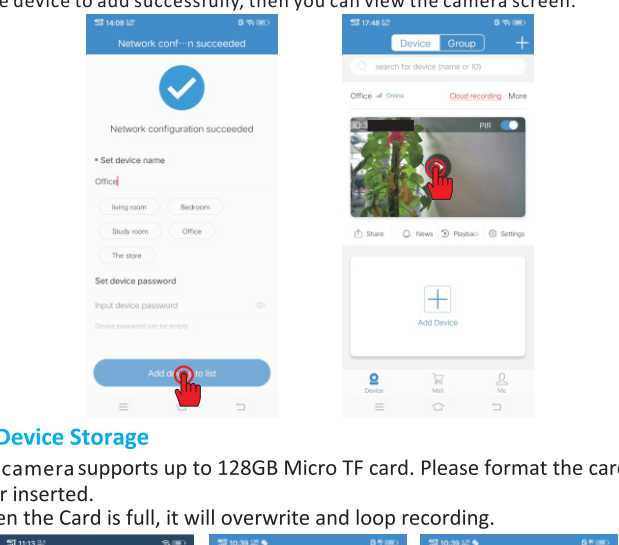

**Step3.** Reset the device and wait for the device indicator to flash and proceed to the next step;



**Step4.** Click “Remote View”, and choose the Wi-Fi the device needs to be connected with (your home Wi-Fi), input the password and click “Next”.

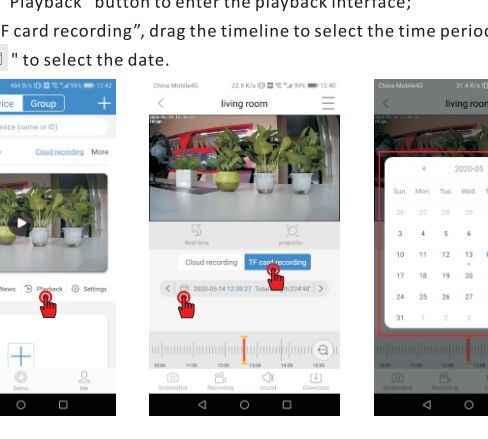

**Step5.** Using the device to scan the QR code on the mobile phone according to the operation the figure shows, then proceed to the next step after hearing the prompt tone.

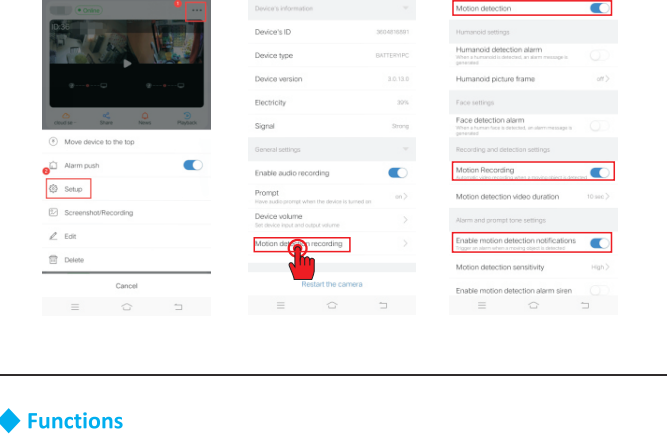

**Step6.** After the network configuration is successful, set the name and password for the device to add successfully, then you can view the camera screen.

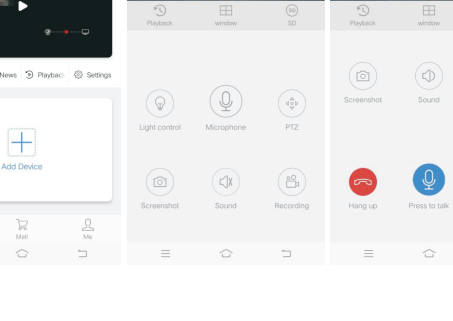

### Device Storage

The camera supports up to 128GB Micro TF card. Please format the card after inserted.

When the Card is full, it will overwrite and loop recording.

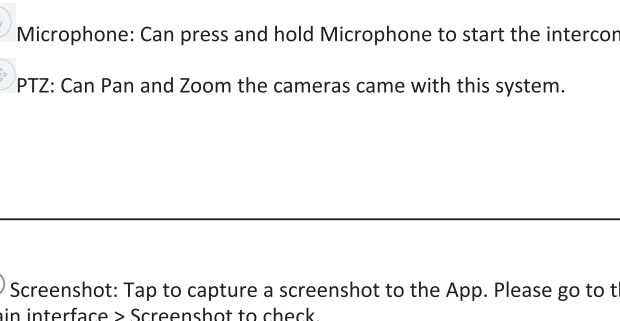

### Remote Playback

- 1) Click the “Playback” button to enter the playback interface;
- 2) Select “TF card recording”, drag the timeline to select the time period;
- 3) Click “ ” to select the date.



### Motion detection alarm

With the function on, the App will push an alarm message to you when a motion is triggered. Click “Settings” and choose “Motion Detection recording”, turn on the “Motion detection”, “Motion Recording” and “Enable motion detection notifications”

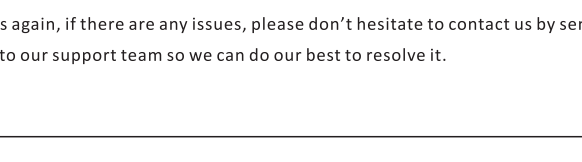

### Functions



**News:** Tap to view alarm messages. Please go to Me > Settings to turn on the Push Notification.

**Playback:** Tap to view the videos recorded.

**Window:** Change the number of channels displayed on the screen.

**SD:** Switch the image quality between SD and HD. SD is the default setting and recommended for smooth streaming.

**Light control:** Adjust the infrared lights mode of cameras.

**Microphone:** Can press and hold Microphone to start the intercom.

**PTZ:** Can Pan and Zoom the cameras came with this system.

**Screenshot:** Tap to capture a screenshot to the App. Please go to the Main interface > Screenshot to check.

**Sound:** Turn on/off the sound from the camera.

**Recording:** Tap to start recording the live video; tap again to end and save it into the App.

**Intercom:** Tap to start talking with people near the NVR. Press and hold the microphone icon to talk; press the icon to hang up.(Note: If this feature can't work, the cameras you ordered don't have this feature)

Thanks again, if there are any issues, please don't hesitate to contact us by sending an email to our support team so we can do our best to resolve it.